

Alaska Native Medical Center Patient Safety Quarterly



Pyxis medstation and anesthesia machine replacement

Between September and November, every Pyxis medstation and anesthesia machine for ANTHC and SCF will be replaced. This is a time intensive, manual process. In preparation for this, pharmacy staff will need to reduce inventory in the machines. From July to September, pharmacy staff worked to remove any non-emergency related medications not used in the last 90 days from each Pyxis machine. If a medication is removed and later needed, please first use the global find option on the Pyxis unit to see if there is another Pyxis with the product. If there is not, contact pharmacy for the medication.

Pharmacy will be reaching out a few days in advance to department leaders to inform them of the date and time their Pyxis will be replaced. The replacement plan includes limited downtime and/or alternative methods to retrieve medications during the replacement process.



In this Issue:

Pyxis medstation and anesthesia machine replacement

Manufacturer's Instructions for Use

Breast Cancer Awareness

MRI Safety Zones

Suicide Prevention Awareness

Just Culture

Earn CE credit for reading PSQ and taking a survey!

Coffee card drawing for taking PSQ survey!

Manufacturer's Instructions for Use (IFUs)

What are Manufacturer's Instructions for Use (IFUs)? Why is it important that we use them and have access to them? And how do we access them?

Making sure reusable instruments and devices are always kept clean after each use is one way to help ensure our patients are safe. Manufacturer's IFUs provide information on how to maintain, clean, and disinfect equipment and what products to use to clean the equipment.

oneSource is a database available to all staff that houses medical equipment and device IFUs directly from the manufacturer. There should be a "Favorites" folder created by your supervisor on oneSource to make it even easier to find the most common equipment items used in your department.

You can access the oneSource database on any of the websites below. Just look for the "Manufacturer IFUs - oneSource" link:

- [The HUB Popular Links](#)
- home.anthc.org
- [Main SharePoint page](#)
- [Nursing SharePoint page](#)
- [Facilities SharePoint page](#)



October is Breast Cancer Awareness Month!

Did you know that breast cancer is the most common type of cancer diagnosed among Alaska Native women? Screenings, such as mammograms, can help find cancer early. Mammograms are used to check for breast cancer, even if there are no signs or symptoms. Finding cancer early, before signs or symptoms, often means it is easier to treat. Please encourage your female patients 40 years of age or older (and yourself and loved ones), to talk to their health care provider about breast cancer screening. Early detection saves lives!

American Indian Cancer Foundation recognizes Indigenous Pink Day on Oct. 19!

Indigenous Pink Day is a national breast cancer awareness campaign for Native people. Breast cancer is the most common cancer among Native women, and is the second leading cause of cancer death. However, all bodies have breast tissue and are at risk for developing breast cancer. Indigenous Pink Day aims to educate Native communities about the importance of early detection, and remind women, men, non-binary, and genderfluid relatives to talk to their doctors about breast cancer screening.

We invite staff to join us on Oct. 19, by wearing pink and sharing photos on social media using the hashtag #IndigenousPink to raise awareness of breast cancer in Indian Country.



MRI Safety Zones

MRI Safety Zones function as physical barriers for increasing levels of security. Each area, or zone, that a person enters requires heightened levels of security beyond that of the general public. In Zone 1, everyone has access; think patient lobby or public hallway. In Zone 2, only someone with access may enter, such as those with a badge or permission. In Zone 3, EVERYONE MUST BE SCREENED to ensure they are safe to enter Zone 4. This means ALL patients and even some employees must be screened.

Zone 4 is the MRI suite where the MRI magnet sits. The MRI magnet is always on! Anyone entering with certain implants and devices, carrying ferrous objects on their person, or pushing an unsafe ferrous stretcher/wheelchair into the room is in danger of serious bodily injury or death. This is why MRI safety zones are so important for all employees to understand. Do you know the zones?

ULMC MRI Zones

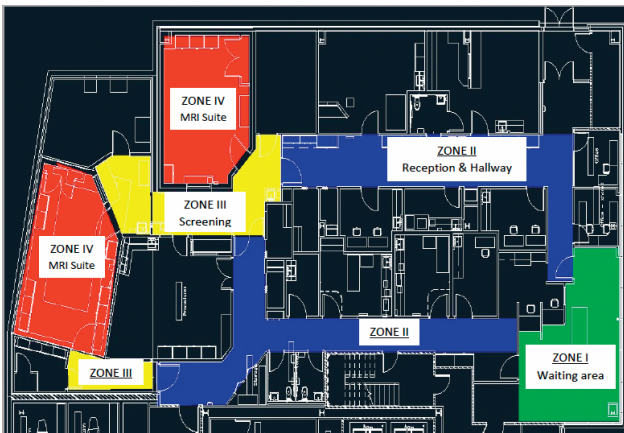

ANMC MRI Zones

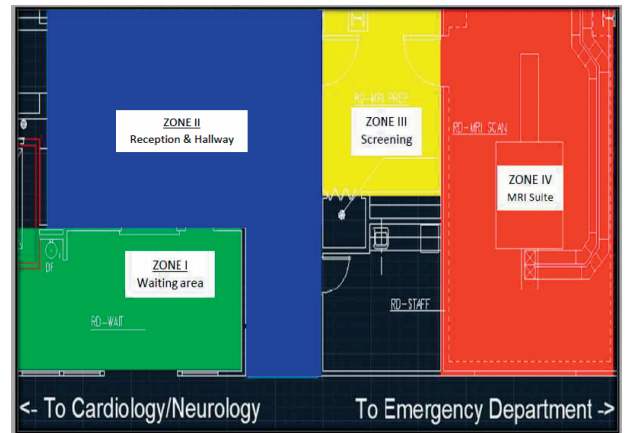

Suicide Prevention Awareness

To honor September as Suicide Prevention Awareness Month, we asked staff to join weekly activities promoting mental, physical, spiritual and emotional wellness. We recognize suicide can be challenging to talk about and it is important to remember that suicide affects everyone.

The 988 Lifeline is a national network of local crisis centers that provides free and confidential emotional support to people in suicidal crisis or emotional distress 24 hours a day, 7 days a week in the United States. We're committed to improving crisis services and advancing suicide prevention by empowering individuals, advancing professional best practices, and building awareness.

Suicide is preventable. As a community, we can help prevent and reduce the numbers by:

- Having meaningful social connections to family, friends, and Elders
- Creating a community support system
- Emphasizing cultural and religious beliefs that support self-preservation
- Knowing the warning signs
- Developing coping and problem-solving skills
- Identifying whether you or someone else has specific mental health needs
- Promoting access to behavioral health specialists
- Seeking help for yourself or someone else
- Reducing the stigmas around mental health and mental illness
- Reducing access to lethal means of suicide, such as guns, poisons, weapons, medications, and other tools that could aid in suicide



Just Culture

We are committed to safety across the organization. Over the summer, Just Culture training was attended by more than 3,200 ANTHC staff. Thank you for participating! Continue to utilize the Just Culture tools as we evolve as a safe organization focused on a culture of learning, safety and trust.

If you have questions, please email justculture@anthc.org. SharePoint site: <https://bit.ly/ANTHCJustCulture>

ANTHC Just Culture (simplified)

<p>Malevolent or Willful Misconduct</p> <p><i>Conscious Disregard of Substantial and Unjustifiable Risk</i></p> <p>Manage through:</p> <ul style="list-style-type: none"> • Remedial action • Corrective action <p style="background-color: white; color: #f4a460; text-align: center; padding: 5px;">Correct</p>	<p>Reckless or At-Risk Behavior</p> <p><i>A Choice: Risk Believed Insignificant or Justified</i></p> <p>Manage through:</p> <ul style="list-style-type: none"> • Removing incentives for at-risk behaviors • Creating incentives for healthy behaviors • Increasing situational awareness <p style="background-color: white; color: green; text-align: center; padding: 5px;">Coach/Counsel/Correct</p>	<p>Possible System or Human Error</p> <p><i>Inadvertent Action Due to Current System Design and Behavioral Choices</i></p> <p>Manage through changes in:</p> <ul style="list-style-type: none"> • Choices • Processes • Procedures • Training • Design • Environment <p style="background-color: white; color: teal; text-align: center; padding: 5px;">Console</p>
---	--	---

Earn CE credit for reading the Patient Safety Quarterly and completing a survey!

In support of improving patient care, ANMC is jointly accredited by the Accreditation Council for Continuing Medical Education, the Accreditation Council for Pharmacy Education, and the American Nurses Credentialing Center, to provide continuing education for the health care team. Pharmacy CPE credit will be posted to the online CPE Monitor system within 60 days following completion of each activity when applicable.

Contact hours:

ANMC designates this activity for a maximum of 2 contact hours, commensurate with participation provided in 0.5 contact hours upon completion of quarterly survey/evaluation tool. Enduring access for credit is available during the month of publication, example: The October 2023 Patient Safety Quarterly will provide access for CE credit until Oct. 31, 2023. This CE opportunity is a communication skills event and not applicable to commercial bias. No mitigation or disclosure is needed.

Requirements for successful completion:

To receive CE credit, please make sure you have read the Patient Safety Quarterly and completed the electronic survey/evaluation tool before the last day of the month published. Scan the QR code to access the survey. For more information, contact jlfielder@anthc.org or 907-729-1387.



qrco.de/bdrV5j



SCAN ME
bit.ly/OctoberPSQ

Complete this survey for a chance to win a coffee card!

Share your thoughts about the ANMC PSQ by scanning the QR code and completing the survey, and you will be entered into a coffee card drawing. Twenty winners will be selected each quarter. The drawing will occur in November.

Do you have a story or something to share in the Patient Safety Quarterly?

Contact the Patient Safety Committee at: patientsafetycommittee@anthc.org